

OPTIONS AVAILABLE FOR THE FOLLOWING COMPONENTS

- TOP CAP – STAINLESS, ALUMINUM, WOOD, ETC.
- HAND RAIL – STAINLESS, ALUMINUM, WOOD, ETC.
- GLASS PANELS – VARIOUS THICKNESS, SHADES, ENGRAVINGS, SHAPES, ETC.
- MATERIAL FINISHES – VARIOUS POLISHES, COATINGS, ETC.

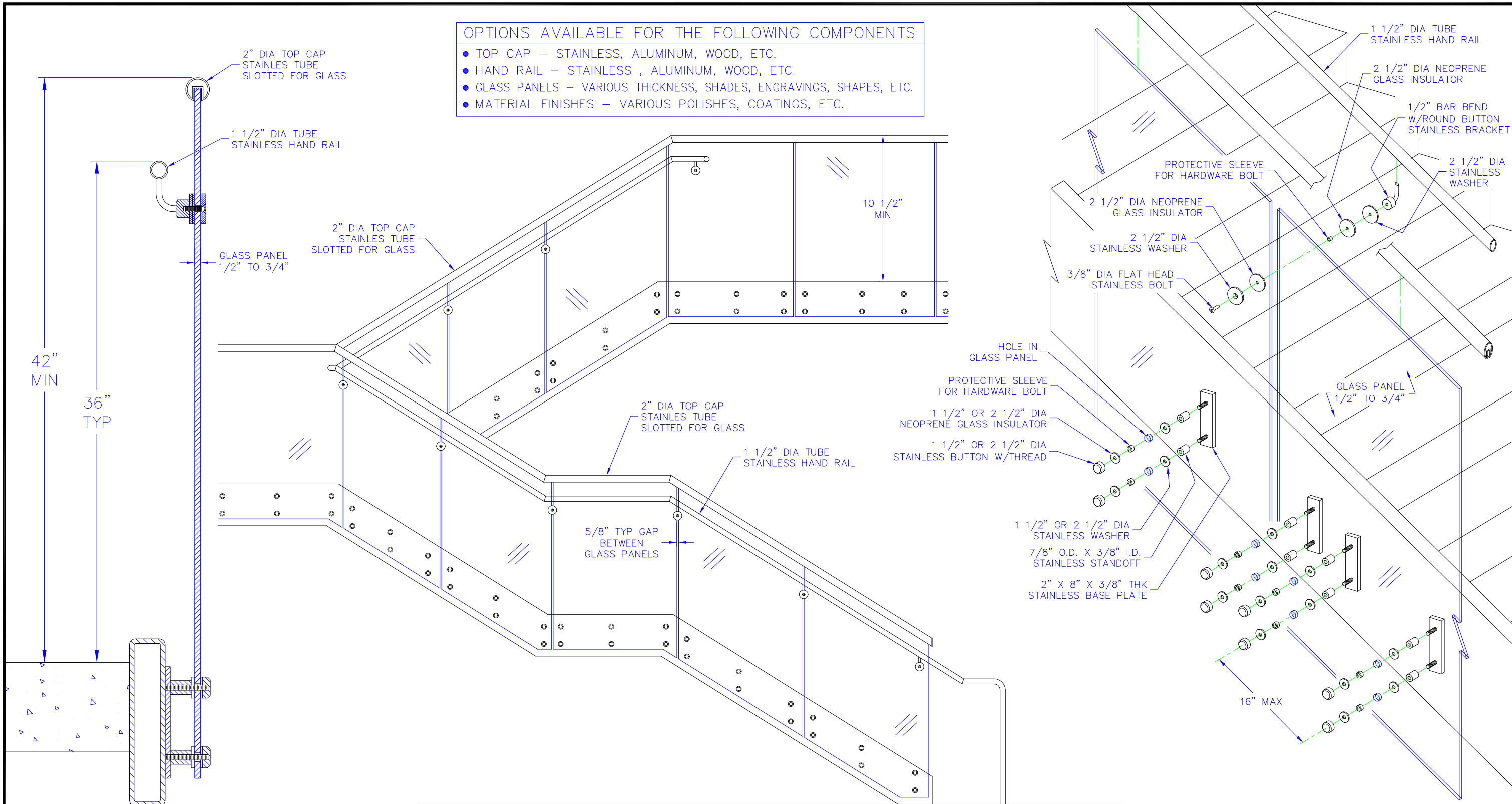

STAINLESS
FABRICATORS, INC.

1834 GUNN HIGHWAY
BUILDING C
ODESSA, FL 33556
EMAIL - www.sales@stainlessfabinc.com
WEBSITE - www.stainlessfabinc.com

PHONE (813)-926-7113
FAX (813)-926-7114

ASSOCIATED PROJECTS
FLORIDA HOSPITAL
SOUTH TOWER
RAKE 6063, 6486, 6280 42"
LEVEL 6484, 5666, 6178 42"

RAILING SERIES
COQUINA - SIDE MOUNT

QUOTE NO. FILE NAME SHEET NO.
COQUINA SERIES B I OF I

OPTION LETTER
B

